

NO. 1 KILMACUD ROAD UPPER, DUNDRUM, DUBLIN 14, D14 EA89
+353.1.205.1490 INFO@TOCTOWNPLANNING.IE
WWW.TOCTOWNPLANNING.IE



Strategic Housing Development
An Bord Pleanála
64 Marlborough Street
Dublin 1

Tuesday, 19th November 2019

Dear Sir/Madam

RE: PHYSICAL PLANNING AID FOR A PLANNING APPLICATION IN RELATION TO A PROPOSED BUILD-TO-RENT DEVELOPMENT AT THE FORMER ALDI SITE, CARMANHALL ROAD, SANDYFORD BUSINESS DISTRICT, DUBLIN 18.

On behalf of the Applicant, Sandyford GP Limited (acting in its capacity as general partner for the Sandyford Central Partnership), we wish to advise that the Applicant has constructed a 1:500 scaled model of the proposed scheme and surrounding context. We wish to invite the Planning Authority, Statutory Consultees and any interested Third Parties to view the above which has been submitted to An Bord Pleanála at their office at No. 64 Marlborough Street, Dublin 1.

Further to the above, we note that photographs of the model are enclosed with this letter.

Yours sincerely

A handwritten signature in black ink that reads "Sadhbh O'Connor". The signature is written in a cursive, flowing style.

Sadhbh O'Connor
Director
Thornton O'Connor Town Planning

Encl.



View from Blackthorn Avenue



Aerial View

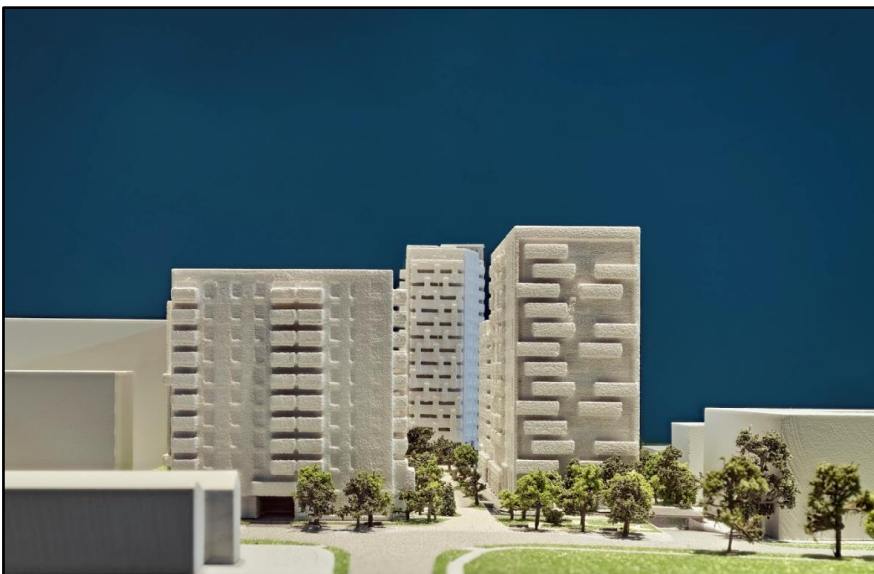

View from Carmanhall Road